



Whitchurch Gardens

Edgware

£899,950

Davidson Frost-Wellings are pleased to offer this beautifully presented four-bedroom, extended, semi-detached house on Whitchurch Gardens, Edgware. Walking distance to Canons Park Station, Edgware Station and the Krishna Avanti Schools.

The ground floor of this property is comprised of a large through lounge, a spacious eat-in kitchen with an island, a pantry and a downstairs bathroom and utility room.

The first floor consists of four bedrooms with the master room containing fitted built-in wardrobes, taking full advantage of the space and a well appointed bathroom containing a standalone bath and a shower.

To the rear of the property, we have a huge and immaculately kept rear private garden, containing a separate patio space.

The location offers access to both Edgware's multiple shopping and transport facilities as well as the local shops and station at Station Parade, Canons Park. Local schools include Woodlands, Aylward Primary and Avanti House as well as The London Academy.

Barnet Council Tax Band F

Viewing

Please contact our Davidson Frost-Wellings Office on 020 8954 8806 if you wish to arrange a viewing appointment for this property or require further information.

- Four bedroom
- Two bathroom
- Beautiful large rear garden
- Downstairs bathroom and utility room
- Close to Avanti house school
- Open Plan Kitchen With Island And Pantry



4



2



2



C

Floor Plan

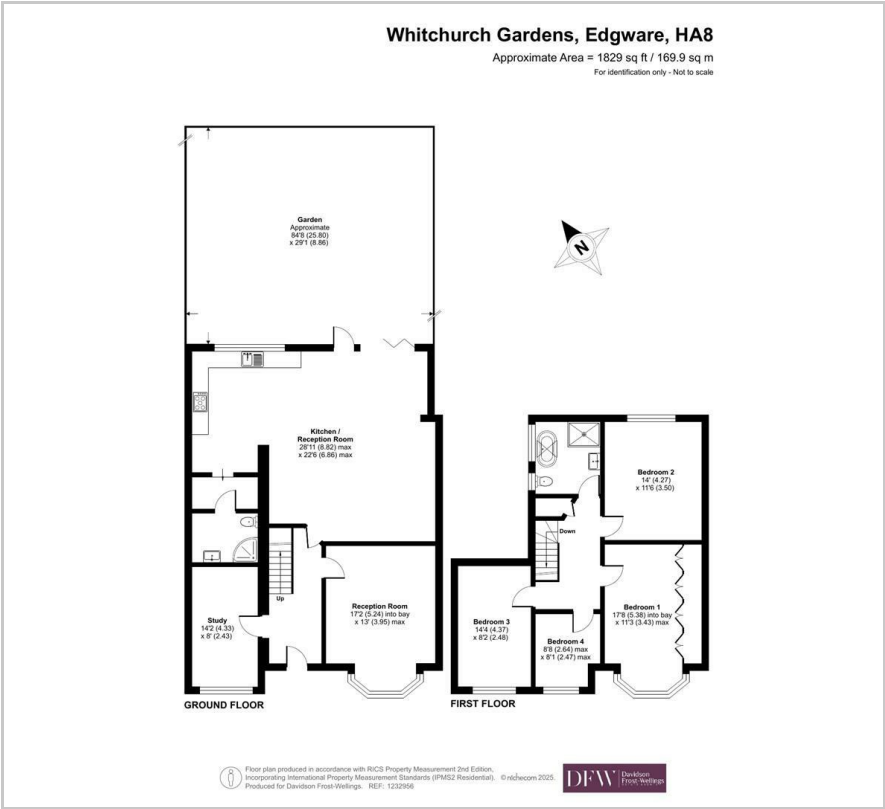

Area Map

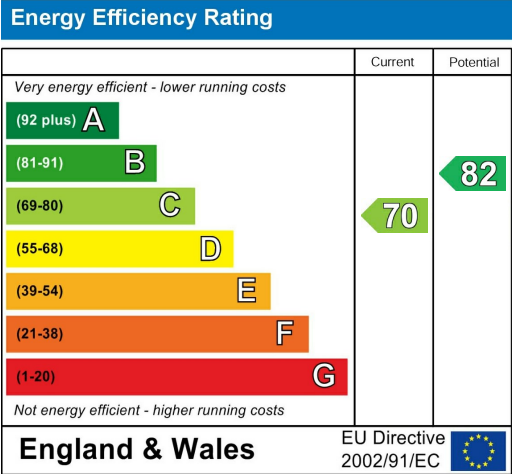
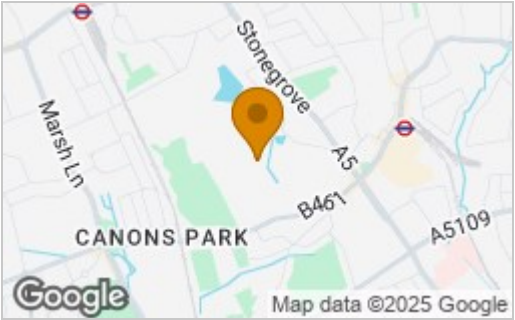

These particulars, whilst believed to be accurate are set out as a general outline only for guidance and do not constitute any part of an offer or contract. Intending purchasers should not rely on them as statements of representation of fact, but must satisfy themselves by inspection or otherwise as to their accuracy. No person in this firms employment has the authority to make or give any representation or warranty in respect of the property.